

# Hypertherm®

## MAX200 Machine torch parts

### MAX200 consumables



MAX200



128380 - Standard body - 2" sleeve



128365 - Stainless steel body

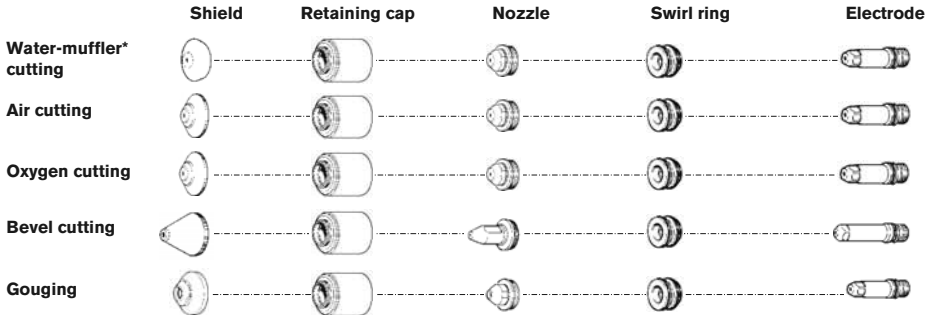

APPLICATION	PLASMA GAS	CONSUMABLE DESCRIPTION	PART NUMBER				QUANTITY PER PACKAGE
			200 AMP BEVEL	200 AMPS	100 AMPS	40 AMPS	
CUTTING	Oxygen	Electrode-Standard	120258	220021	120547	_____	5
		Electrode-SilverPlus	_____	220083	_____	_____	5
		Swirl ring	120833	020604	020617	_____	1
		Nozzle	120259	020605	020616	_____	5
		Retaining cap	020423	020423	020423	_____	1
		Retaining cap, ohmic	120837	120837	120837	_____	1
		Shield	120260	020424	020448	_____	1
		(Water muffler*) Shield	_____	020566	020618	_____	1
	Air	Electrode	_____	220021	120547	120667	5
		Swirl ring	_____	020607	020607	020613	1
		Nozzle	_____	020608	020611	020689	5
		Retaining cap	_____	020423	020423	020423	1
		Retaining cap, ohmic	_____	120837	120837	120837	1
		Shield	_____	020424	020448	020688	1
		(Water muffler*) Shield	_____	020566	020618	_____	1
		Argon/Hydrogen	Electrode	_____	020415	020415	_____
	Swirl ring		_____	020607	020607	_____	1
	Nozzle		_____	020608	020611	_____	5
	Retaining cap		_____	020423	020423	_____	1
	Retaining cap, ohmic		_____	120837	120837	_____	1
Shield	_____		020602	020448	_____	1	
Nitrogen	Electrode		_____	020415	_____	_____	5
	Swirl ring		_____	020607	_____	_____	1
	Nozzle	_____	020608	_____	_____	5	
	Retaining cap	_____	020423	_____	_____	1	
	Retaining cap, ohmic	_____	120837	_____	_____	1	
	Shield	_____	020424	_____	_____	1	
	(Water muffler*) Shield	_____	020566	_____	_____	1	
	GOUGING	Air	Electrode	_____	220021	_____	_____
Swirl ring			_____	020607	_____	_____	1
Nozzle			_____	020615	_____	_____	5
Retaining cap			_____	020423	_____	_____	1
Shield			_____	020485	_____	_____	1
Argon/Hydrogen		Electrode	_____	020415	_____	_____	5
		Swirl ring	_____	020607	_____	_____	1
		Nozzle	_____	020615	_____	_____	5
		Retaining cap	_____	020423	_____	_____	1
		Shield	_____	020485	_____	_____	1

\* Water muffler cannot be used with 2" 120356 stainless steel torch or with ohmic height sensing.

**Genuine Hypertherm Consumables**

*The only way to ensure maximum performance*

# MAX200 machine torch assembly

128380 – Standard body – 2" sleeve  
 128364 – Optional body – 1 3/4" sleeve

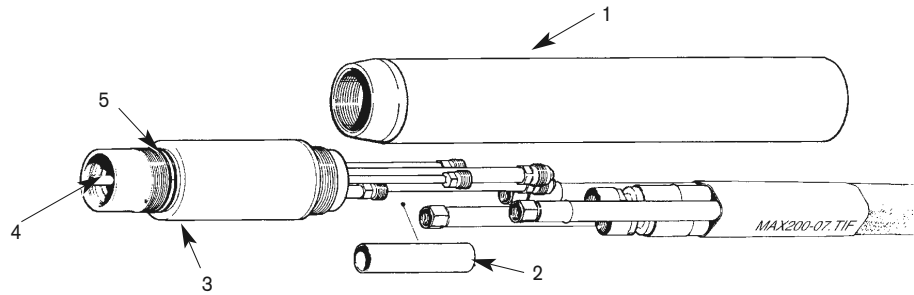

**128380 – Standard body – 2" sleeve**

ITEM NUMBER	STANDARD BODY (2") PART NO.	DESCRIPTION	OPTIONAL BODY (1 3/4") PART NO.
	128380 <sup>^</sup>	MAX200 machine torch assembly	128364
	028383*	Leads, torch, 25' / 7.6 m	028383
	028384*	Leads, torch, 50' / 15.2 m	028384
1	120894	Torch mounting sleeve	020431
2	020536	Lead insulator, 9/16 x 2.5"	020536
3	120584	MAX200/HT2000 machine torch main body	120584
4	020963	Water tube, electrode cooling, standard	020963
4	120257	Water tube, electrode cooling, extended	120257
5	044027	O-ring: Buna 70 Duro 1.301 x .070	044027 <sup>^</sup>

<sup>^</sup> Assembly includes consumables

\* Other lead lengths available.  
 Consult your Operator Manual.

128365 – Stainless steel body

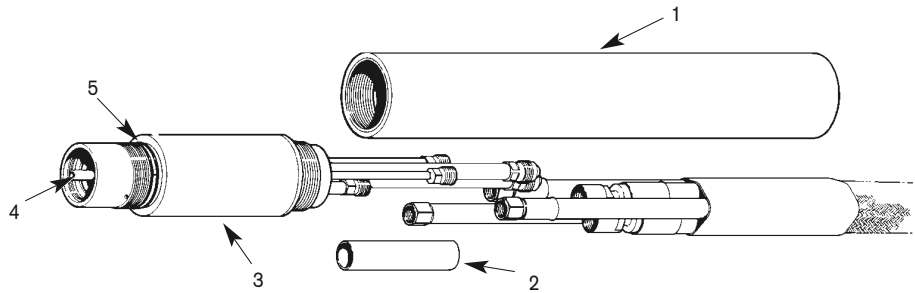

**128365 – Stainless steel body**

ITEM	PART NUMBER	DESCRIPTION
	128365 <sup>^</sup>	MAX200 machine torch assembly
	120356	MAX200/HT2000 machine torch main body
	028384*	Leads, torch, 50' / 15.2 m
1	020041	Torch mounting sleeve
2	020536	Lead insulator, 9/16 x 2.5"
3	028383*	Leads, torch, 25' / 7.6 m
4	020963	Water tube, electrode cooling, standard
4	120257	Water tube, electrode cooling, extended
5	044027	O-ring: Buna 70 Duro 1.301 x .070

<sup>^</sup> Assembly includes consumables

\* Other lead lengths available.  
 Consult your Operator Manual.

Hypertherm, and MAX are trademarks of Hypertherm, Inc. and may be registered in the United States and/or other countries.

## Hypertherm<sup>®</sup>

The world leader in plasma cutting technology™

www.hypertherm.com

**Hypertherm, Inc.** USA 603-643-3441 Tel 603-643-5352 Fax consumable.info@hypertherm.com

**Hypertherm Automation** USA 603-298-7970 Tel 603-298-7977 Fax info@hyperthermautomation.com

**Hypertherm Plasmatechnik GmbH** Deutschland 49 6181 58 2100 Tel 49 6181 58 2134 Fax

HTDeutschland.info@hypertherm.com

**Hypertherm (S) Pte Ltd.** Singapore 65 6841 2489 Tel 65 6841 2490 Fax

HTSingapore.info@hypertherm.com

**Hypertherm (Shanghai) Trading Co., Ltd.** PR China 86-21 5258 3330 /1 Tel 86-21 5258 3332 Fax

HTChina.info@hypertherm.com

**Hypertherm** Branch of Hypertherm UK, LLC England 00 800 3324 9737 Tel 00 800 4973 7329 Fax

HTUK.info@hypertherm.com

**France (Representative office)** 00 800 3324 9737 Tél 00 800 4973 7329 Fax HTFrance.info@hypertherm.com

**Hypertherm Europe B.V.** Nederland 31 165 596907 Tel 31 165 596901 Fax

HTEurope.info@hypertherm.com

**Hypertherm Japan Ltd.** 81 6 6170 2020 Tel 81 6 6170 2015 Fax HTJapan.info@hypertherm.com

**Hypertherm Brasil Ltda.** 55 11 2409 2636 Tel 55 11 2408 0462 Fax HTBrasil.info@hypertherm.com

**Hypertherm México, S.A. de C.V.** 52 55 5681 8109 Tel 52 55 5683 2127 Fax ventas@hypertherm.com.mx

**Australia/New Zealand (Representative office)** 61 (0) 7 3219 9010 Tel 61 (0) 7 3219 9012 Fax sales.au@hypertherm.com